



Seal Type 21 - Rubber Bellow (EN 12756)

PRODUCT DESCRIPTION

The Seal Type 21 is a Compact Single Spring Rubber Bellow Mechanical Seals for universal general purpose for Water / Water Based Solution like Oils, Fuels and Other Fluids and even with some Content with Abrasive and for a very wide operating condition designed for Centrifugal Pump. Rotary Equipment and Industrial applications (Food Processing, Water System, Waste Water Treatment for Petrochemical Processing, Pulp and Paper)

DESIGN FEATURES

Single, low cost and mass produced Mechanical Seal with Rubber Bellow. Central Point Non-Clogging Coil Spring Seal. Spring Design Seal is suitable for dual-direction of Shaft Rotation. Bellow Design Seals for Pressure supported and eliminates folds. Bellow Seals Protecting against Twisting. Unitize, easy-to-fit design seals

MATERIALS

Seal Ring Faces : Carbon, SiC and TC
Seat Faces : NiR, Ceramic, SiC and TC
Elastomer : Viton, Neoprene, EPDM, NBR and Buna-N
MOC : SS 304 / SS 316

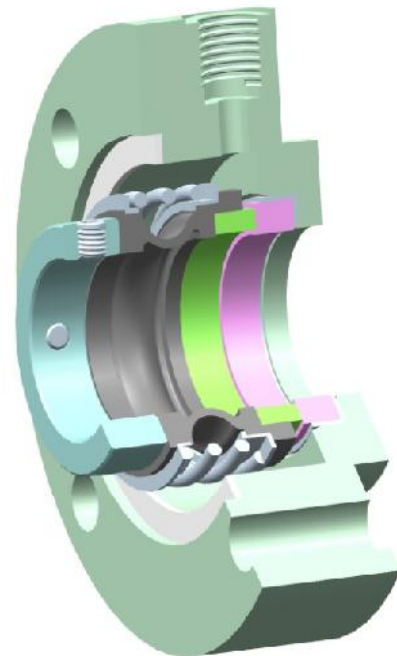

OPERATING CAPABILITIES

Shaft Dia. : 10mm to 100mm
Pressure : Up to 8 bar
Temperature: -20°C to 180°C
Speed : 3000 r.p.m.

Type - 21

Rubber Bellow

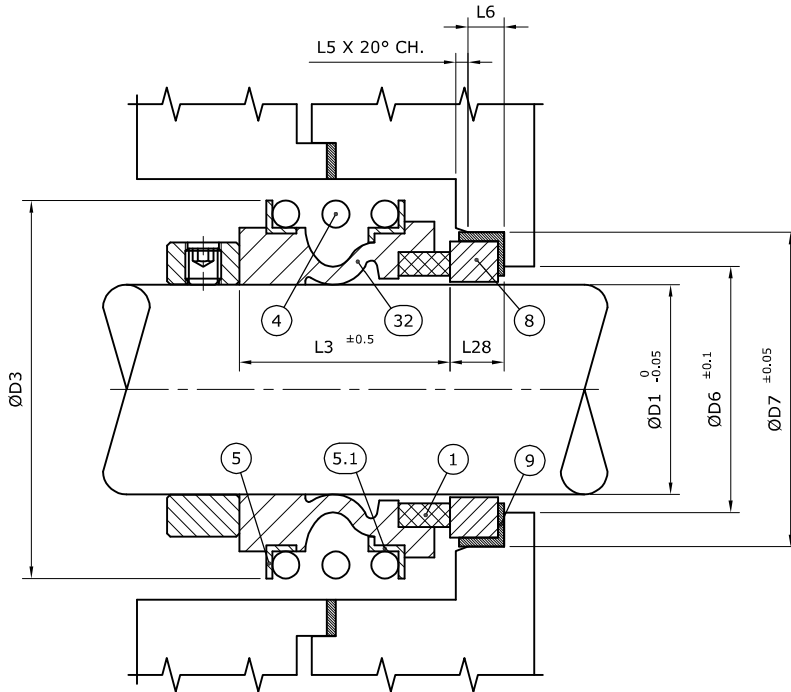

Part No.	Description
1	Seal Ring
4	Spring
5	Spring Holder
5.1	Spring Holder
8	Seat
9	Packing
32	Bellow

SEAL SIZE							
D1	D3	D6	D7	L3	L5	L6	L28
10.0	23.0	17.0	21.0	15.0	1.5	4.0	6.6
12.0	25.5	19.0	23.0	15.5	1.5	4.0	6.6
14.0	29.0	21.0	25.0	17.5	1.5	4.0	6.6
16.0	29.0	23.0	27.0	17.5	1.5	4.0	6.6
18.0	32.5	27.0	33.0	20.0	2.0	5.0	7.5
20.0	37.5	29.0	35.0	22.0	2.0	5.0	7.5
22.0	37.5	31.0	37.0	22.0	2.0	5.0	7.5
24.0	43.0	33.0	39.0	23.0	2.0	5.0	7.5
25.0	43.0	34.0	40.0	23.0	2.0	5.0	7.5
28.0	49.5	37.0	43.0	27.0	2.0	5.0	7.5
30.0	49.5	39.0	45.0	27.0	2.0	5.0	7.5
32.0	54.0	42.0	48.0	28.0	2.0	5.0	7.5
33.0	54.0	42.0	48.0	28.0	2.0	5.0	7.5
35.0	57.5	44.0	50.0	29.0	2.0	5.0	7.5
38.0	59.5	49.0	56.0	30.5	2.0	6.0	9.0
40.0	62.5	51.0	58.0	30.5	2.0	6.0	9.0
43.0	68.5	54.0	61.0	30.5	2.0	6.0	9.0
45.0	71.0	56.0	63.0	30.5	2.0	6.0	9.0
48.0	74.5	59.0	66.0	31.0	2.0	6.0	9.0
50.0	79.0	62.0	70.0	31.0	2.5	6.0	9.5
53.0	81.5	65.0	73.0	33.5	2.5	6.0	11.0
55.0	86.0	67.0	75.0	35.5	2.5	6.0	11.0
58.0	89.0	70.0	78.0	37.5	2.5	6.0	11.0
60.0	90.0	72.0	80.0	38.5	2.5	6.0	11.0
63.0	94.0	75.0	83.0	38.5	2.5	6.0	11.0
65.0	97.0	77.0	85.0	40.5	2.5	6.0	11.0
68.0	97.0	81.0	90.0	40.5	2.5	7.0	11.3
70.0	100.0	83.0	92.0	40.5	2.5	7.0	11.3
75.0	108.0	88.0	97.0	40.5	2.5	7.0	11.3
80.0	113.0	95.0	105.0	40.5	3.0	7.0	12.0

Due to continuous improvement specifications and dimensions may change without prior notice.